

Insert Style Die Grinders For Carbide Burrs & Mounted Stones

DIE GRINDERS



- Air Inlet Size:**
250GE/250HGE/300GE/300HGE: 1/4" NPT
400GE/400HGE: 3/8" NPT
- Hose Size Recommendations:**
250GE/250HGE/300GE/300HGE: 3/8" (10mm)
400GE/400HGE: 1/2" (13mm)
- Extra Charge Accessories**
- Safety Lever
- Standard Equipment**
- Tool • Operating Instructions and Service Manual
 - 2 Wrenches (sizes based on options)

Quick Order Number					
This chart has been provided as a means to quickly identify a particular tool. The ordering numbers listed represent the most common versions of our tools. If more specialized versions are required, please build your model number per the following model number flow chart.					
Model Number	Power	Collet Size	Maximum Operating Speed	Throttle Handle Type	
				Standard	Safety
The tools listed below are designated with aluminum case material and rear exhaust. Please consult the Model Breakdown section below if alternative options are desired.					
250GE	0.4 H.P.	1/4	40000 RPM	250GE;1/4	250GEK;1/4
250HGE				250HGE;1/4	250HGEK;1/4
300GE	0.7 H.P.		30000 RPM	300GE;1/4	300GEK;1/4
300HGE				300HGE;1/4	300HGEK;1/4
The tools listed below are designated with steel case material and side exhaust. Please consult the Model Breakdown section below if alternative options are desired.					
400GE	1.2 H.P.	1/4	20000 RPM	400GES;1/4	400GESK;1/4
400HGE				400HGES;1/4	400HGESK;1/4

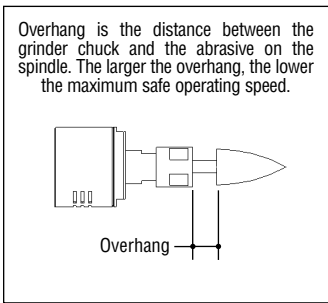

Example Model Number: **300GE K S F ; 28000 ; 1/4**

Model Number	Lever Style	Case Material	Exhaust Direction	Operating Speed	Collet Size
250GE	Please choose one of the following options: No Designation - Standard Lever K - Safety Lever	Please choose one of the following options: No Designation - Aluminum Case S - Steel Case	Please choose one of the following options: No Designation - Rear Exhaust F - Front Exhaust	40000 : 40000 R.P.M	Please choose one of the following options: 1/8 - 1/8 Inch Collet 1/4 - 1/4 Inch Collet 3/8 - 3/8 Inch Collet 3MM - 3mm Collet 6MM - 6mm Collet 8MM - 8mm Collet
250HGE				30000 : 30000 R.P.M	
300GE			Please choose one of the following options: No Designation - Side Exhaust R - Rear Exhaust F - Front Exhaust	18000 : 18000 R.P.M	
300HGE				20000 : 20000 R.P.M	
400GE					
400HGE					
400SH					
400SH+6					

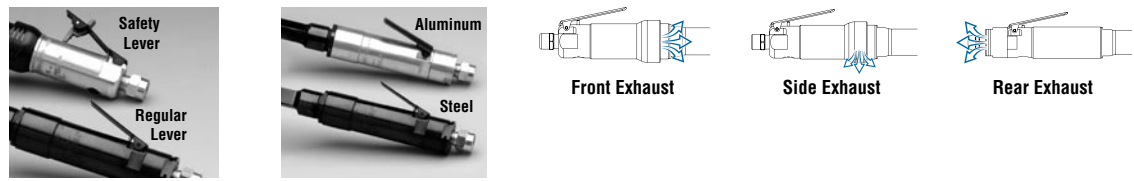

WARNING: Follow all recommendations from component and abrasive manufacturers for speeds and proper usage.

250GEK/300GEK

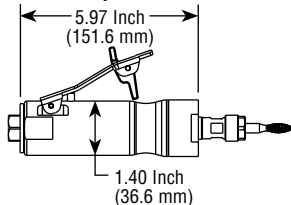

250GE: 0.4 H.P. (300 W)
300GE: 0.7 H.P. (525 W)



Aluminum 250GE - 1.1 Lb. (0.5 Kg) 1.6 Lb. (0.7 Kg)
Steel 300GE - 1.2 Lb. (0.5 Kg) 1.7 Lb. (0.8 Kg)



250GE: 18 cfm (8.5 L/s) Max.
300GE: 25 cfm (11.8 L/s) Max.

250HGEK/300HGEK

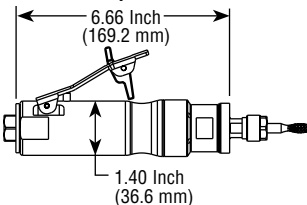

250HGE: 0.4 H.P. (300 W)
300HGE: 0.7 H.P. (525 W)



Aluminum 250HGE - 1.2 Lb. (0.7 Kg) 1.7 Lb. (0.8 Kg)
Steel 300HGE - 1.3 Lb. (0.6 Kg) 1.9 Lb. (0.9 Kg)



250HGE: 18 cfm (8.5 L/s) Max.
300HGE: 25 cfm (11.8 L/s) Max.

400GEK*

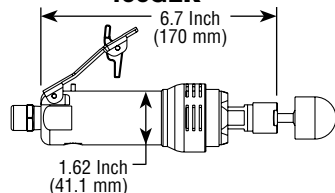

*Rear exhaust adds 0.82 Inch (20.8mm) to overall length.



1.2 H.P. (900 W)



1.7 Lb. (0.8 Kg) Aluminum
2.5 Lb. (1.1 Kg) Steel



35 cfm (16.5 L/s) Max.

400SH*

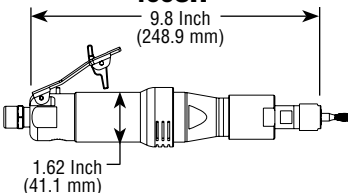

*Rear exhaust adds 0.82 Inch (20.8mm) to overall length.



1.2 H.P. (900 W)



2.4 Lb. (1.1 Kg) Aluminum
3.3 Lb. (1.5 Kg) Steel



35 cfm (16.5 L/s) Max.

400HGEK*

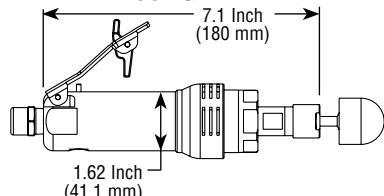

*Rear exhaust adds 0.82 Inch (20.8mm) to overall length.



1.2 H.P. (900 W)



1.8 Lb. (0.8 Kg) Aluminum
2.5 Lb. (1.1 Kg) Steel



35 cfm (16.5 L/s) Max.

400SH+6*

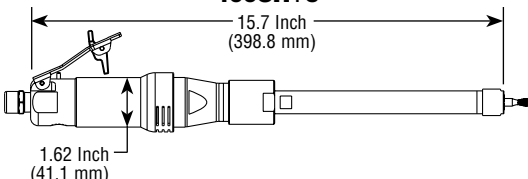

*Rear exhaust adds 0.82 Inch (20.8mm) to overall length.



1.2 H.P. (900 W)



3.2 Lb. (1.4 Kg) Aluminum
4.1 Lb. (1.9 Kg) Steel



35 cfm (16.5 L/s) Max.

**250GE
300GE
400GE**

Single Front Bearing

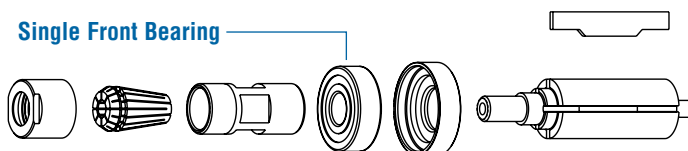

**250HGE
300HGE
400HGE**

Double Front Bearing

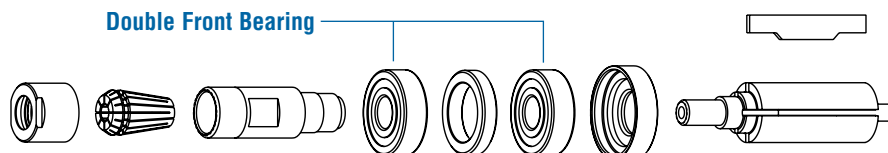

**400SHD
400SHD+6**

3 Front Bearings

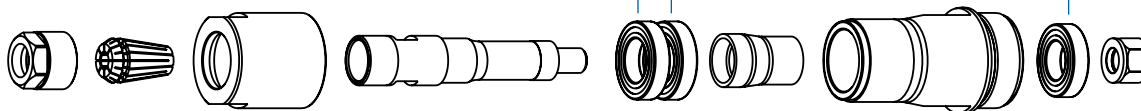

Extreme Duty